

TYPICAL REPAIR METHOD FOR REPLACING STRONGBACKS FOR AN EXISTING FLOOR

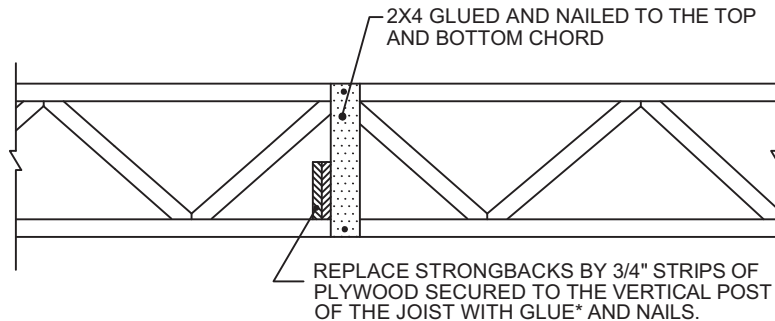

1. Insert 3/4" X 8'-0" strips of plywood (the same height as the necessary strongbacks) into the joist.
2. Secure the first strip of plywood to the vertical post with glue* and two 2" nails.
3. Alternate joints by at least 2'-0" for the other plywood strips.
4. Secure the second strip of plywood with glue* and a row of 1 1/2" screws @ 16" o.c., at 1" from the top and 1" from the bottom.
5. The strongbacks can be interrupted (e.g., for pipes) provided each is secured to at least three joists on either side of the interruption.

*PL Premium Glue

RTF-004-18

IMPORTANT NOTICES

This detail drawing is valid for uniform residential loads.

For other types of loads, contact the manufacturer.

Check out the www.openjoisttriforce.com website for the latest updates.

